



N 2093 County Road N, Appleton, WI 54913
www.vandeheycompany.com

Do-It-Yourself

and get professional results



Congratulations, you are ready to begin the do-it-yourself process. This do-it-yourself guide is designed to walk you through the necessary steps to a professionally designed landscape. If you have any questions during the process don't hesitate to call us at (920) 788-6344. Please bring this completed guide with you to your scheduled appointment. We look forward to working with you.

STEP ONE

To help us create a quality landscape design that is not only eye-catching, but unique and functional, please respond to following questions.

1. What areas are you considering for landscaping?

Front ____ Back ____ Side ____ Foundation ____ Yard Perimeter ____

Other: _____

2. How long have you lived in your current home? _____ How long do you intend to stay? _____

3. What would you like to have in your landscape?

Lawn Seed ____ Sod ____ **Is the area:** Sunny ____ Shady ____

Plants Trees ____ Hedges ____ Perennials ____

Evergreen Trees ____ Flowering Shrubs ____ Annuals ____

Flowering Trees ____ Non – Flowering Shrubs ____ Bulbs ____

Fruit Trees ____ Evergreen Shrubs ____ Groundcovers ____

Specific Plant Likes: _____

Specific Plant Dislikes: _____

Specific Color Likes: _____

Specific Color Dislikes: _____

Mulch Shredded Bark ____ Cedar ____ Stone ____ Other ____

Edging Hand Spaded Edge ____ Plastic Edging ____ Concrete Edging ____

Patio/Walk Brick ____ Flagstone ____ Concrete ____

4. Are there any features you would like to include in your landscape?

Native Plants ____ Butterfly Garden ____ Wildlife Attraction ____ Fire Pit ____ Fence ____

Annual Garden ____ Rain Garden ____ Bird Attraction ____ Clothesline ____ Outdoor

Perennial Garden ____ Herb Garden ____ Play Area ____ Basketball Hoop ____ Kitchen ____

Vegetable Garden ____ Shade Garden ____ Entertainment Area ____ Privacy Screen ____

6. On a scale of 1-10, 10 being the highest, how important is your outdoor living environment to you? ____

7. On a scale of 1-10, 10 being the highest, what level of maintenance do you expect to do on your landscape? ____

8. What areas concern you? (drainage problems, steep slopes, old pavement, streetlights, noise, unsightly views, soil conditions?)

9. What is your ideal time frame for completing your landscape project? _____

10. What is the budget for your landscape projects

Immediate _____ Long term _____

Please attach an additional sheet of paper with any comments you feel are important.

STEP TWO

Understanding the layout of your house and it's relation to your property is important in the design process. Please take some time to accurately measure and draw to scale the area to be designed and plant material you want to remain. On the next page is a grid for you to use to draw your property. Please use the following steps as a guide for measuring. Refer to the image below as an example. Check the box when each step is complete.

1. If available, refer to your house plans and plot map for easy measuring.
2. Measure the length of each side of the house .
3. Measure and locate all doors and windows. Indicate doors and direction of it's swing with an arch. Indicate windows with a thick line (see example below).
Label basement windows, with "LW" (lower window).
5. Each house is unique, remember to measure and locate any chimneys, breezeways, bay windows, etc.
6. Measure, locate and label all air conditioners, water hose hook ups, heat dryer vents, downspouts, electric, etc.
Label air conditioner with (A), water hook ups with (W), vents with (V), Downspouts with (D), etc.
7. Measure the distance from each corner of you house to the property line if necessary. Measure the distance from the front corners of your house to the road.
8. Measure and locate all permanent features such as driveways, walkways, patios, decks, etc.
9. Locate and label all existing plant material you want to remain with a circle.
10. Measure and locate existing planting bed lines. Note existing edging type, (concrete, plastic, etc.)
11. Indicate the direction of North.

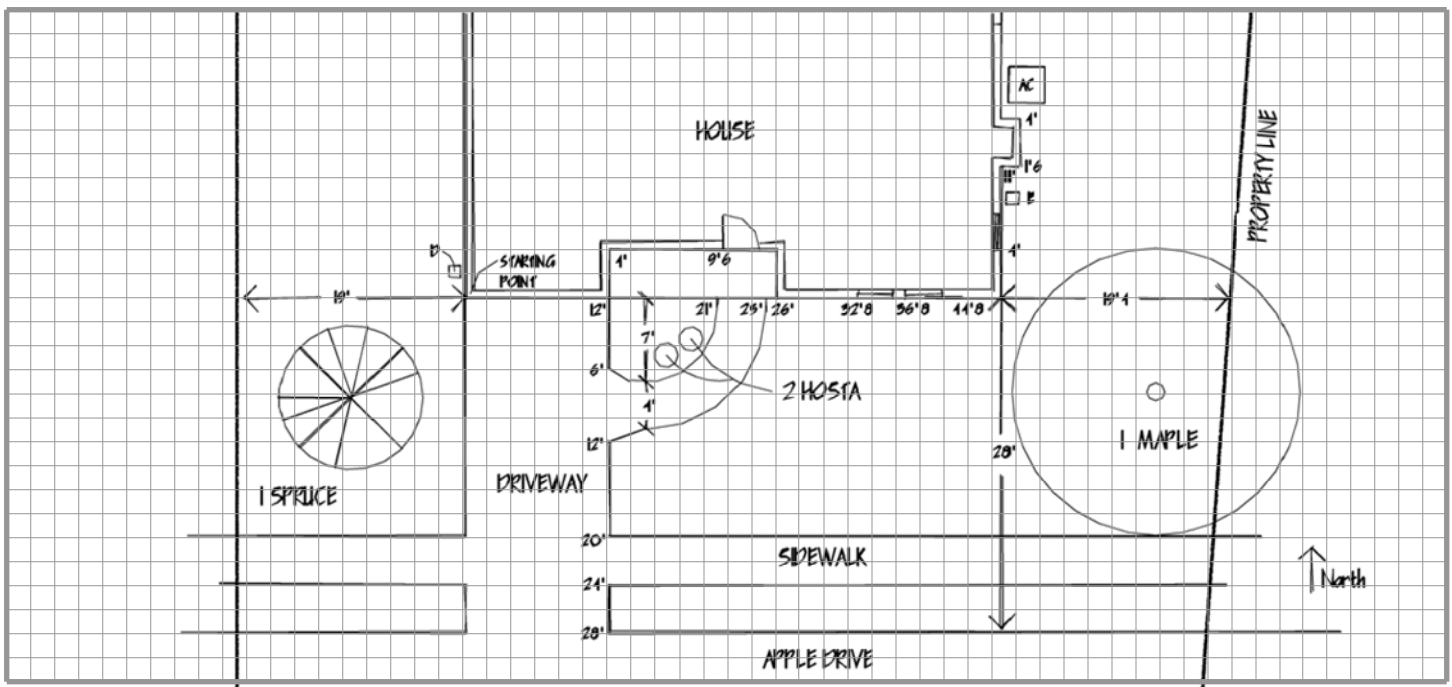

STEP THREE

It is of great importance that we see the architecture of your house, the property layout, and the surrounding areas. **Please take several photos of your house and property.** If you are concentrating your landscape design on a specific section of your yard please take any photos that are relevant to that area. E-mail digital pictures to Vande Hey's at, diy@vandeheycompany.com, or bring a hardcopy of the photos with you at your scheduled appointment.



Each square on the grid represents one square foot. If the section of your yard you would like designed does not fit at that scale, each square can represent two square feet. If the grid is still too small you may photo copy the grid and use multiple pages, but each square should represent no more than two square feet. It is best to use a pencil.

